



Hatcliffe Close £895,000 Freehold

Delightful Town House with a sunny south east facing garden situated in a sought after small development just moments from Blackheath Village. All the amenities of the Village are just a few minutes walk including the Station with it's fast and frequent service to The City and Victoria and a one stop change to the DLR for Canary Wharf. The shops restaurants cafes and bars are all on one's doorstep but the house is in a secluded and quiet spot.

KERSHAW'S



KERSHAW'S

Laid out over three floors and having a front to back Kitchen/Dining/Living Room on the ground floor opening onto the sunny garden. First floor Living Room, Three Double Bedrooms and Two Shower Rooms; one En-suite plus the addition of a Loft Room accessed via an electronic Stair Ladder. Ground Floor Cloakroom. Off road parking for two cars.

Approximate Area = 141.5 sq m / 1523 sq ft
Including Limited Use Area (6.4 sq m / 69 sq ft)

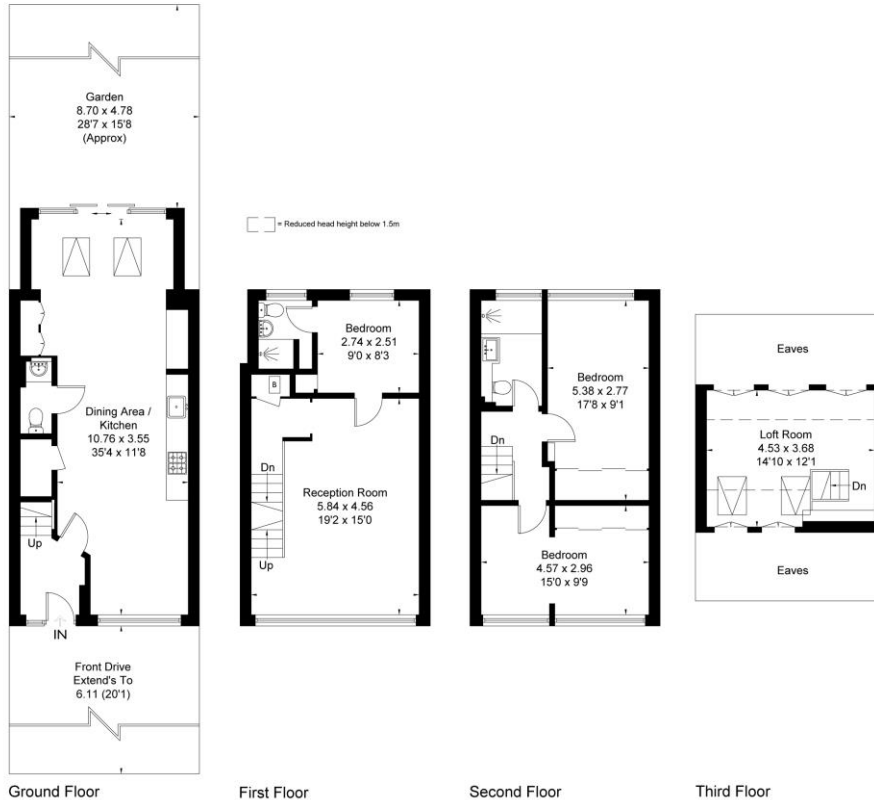

Surveyed and drawn in accordance with the International Property Measurement Standards (IPMS 2: Residential)
fourwalls-group.com 57291

Energy Efficiency Rating			
Score	Energy rating	Current	Potential
92+	A		
81-91	B		85 B
69-80	C	75 C	
55-68	D		
39-54	E		
21-38	F		
1-20	G		